



1. RULES

The races will be governed by the rules as defined in the 2021-2024 Racing Rules of Sailing (RRS), and PHRF-LE Class Rules. Each yacht must conform to the USCG requirements for their vessel and monitor VHF Ch 71 while racing.

2. NOTICES TO COMPETITORS

Notices to competitors will be posted on the official notice board located in the Recreation Room of MBC, and the waterside windows of the club.

3. CHANGES TO SAILING INSTRUCTIONS

Any change to the sailing instructions will be posted on the official notice board not later than one hour before the affected race.

4. SIGNALS MADE ASHORE

Signals made ashore will be displayed from the flagpole located near the waterside of MBC. When flag AP is displayed ashore, "1 minute" is replaced with "not less than 60 minutes" in the race signal AP.

5. SCHEDULE OF RACES

Open registration and competitors' meeting will be held at MBC on Tuesday, May 16th from 6-7 pm. The scheduled time of the warning signal will be at 6:55 pm for each race.

SCHEDULE:

REGISTRATION: Tuesday, May 16th, 6-7 pm and ONLINE at <http://www.noticeofrace.net>

RACING: Tuesday evenings, May 23rd through August 29th.

SPRING SERIES: May 23, 30, June 6, 13, 20, 27, July 11 (No Race July 4th)



SUMMER SERIES: July 18, 25, August 1, 8, 15, 22, 29

RUM SERIES: Sep 5, 12, 19

THERE WILL BE NO MAKEUP RACES SCHEDULED IF A RACE IS CANCELLED FOR ANY REASON

6. CLASS FLAGS AND ORDER OF STARTS

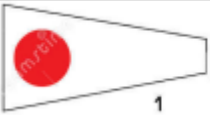
Classes will start in the following order: One PHRF start followed by one JAM start
 Approximate Starting Times: 6:55 pm Warning Signal (PHRF)
 Class code flags as below :

		
#1 PHRF	#2 JAM	#3 Optional
7:00 PM start	7:05 PM start	7:10 Start

On-water postponement: Code Flag "AP" and two sound signals. The Warning Signal will be made one minute after lowering the "AP" flag.

7. RACING AREA

The racing area will be in western Lake Erie from the MBC/NCYC North mark in La Plaisance Bay, using the MBC/NCYC Racing Marks. (See “Exhibit A”)

8. MARKS

All marks will be orange can buoys, identified with “NCYC Racing Mark.”

9. COURSES

The courses may be triangular or windward-leeward. The race committee signal boat will display the selected course, designated by a black number on a white background indicating marks to round and rounding order no later than the warning signal.

Course #	Class	Rounding Marks - (direction)	Nautical Miles
1	PHRF	Start-W-E-Finish (port)	6.8
	JAM	Start-W-C-Finish (port)	4.8
2	PHRF	Start-W-S-Finish (port)	6.8
	JAM	Start-W-C-Finish (port)	4.8
3	PHRF	Start-S-W-Finish (stbd)	6.8
	JAM	Start-C-W-Finish (stbd)	4.8
4	PHRF	Start-S-E-Finish (port)	6.8
	JAM	Start-C-E-Finish (port)	4.8
5	PHRF	Start-E-W-Finish (stbd)	6.8
	JAM	Start-E-C-Finish (stbd)	4.8
6	PHRF	Start-E-S-Finish (stbd)	6.8
	JAM	Start-E-C-Finish (stbd)	4.8
7	ALL	Start-W-C-Finish (port)	4.8
8	ALL	Start-C-W-Finish (stbd)	4.8
9	ALL	Start-E-C-Finish (stbd)	4.8
10	ALL	Start-C-E-Finish (port)	4.8
11	ALL	Start-W-Finish (port)	4.0
12	PHRF	Start-W-N-W=Finish (port)	8.0
	JAM	Start-W-Finish (port)	4.0
13	ALL	Start-S-Finish (port)	5.6
14	PHRF	Start-S-N-C-Finish (port)	8.4
	JAM	Start-S-Finish (port)	5.6
15	ALL	Start-E-Finish (port)	4.0
16	PHRF	Start-E-N-E-Finish (port)	8.0
	JAM	Start-E-Finish (port)	4.0

10. THE START

Races will be started in accordance with RRS 26 with the warning signal given 5 minutes before the starting signal. The starting line will be between an orange flag on the R/C boat and the North mark. Boats whose warning signal has not been made shall avoid the starting area.

11. INDIVIDUAL RECALLS

The R/C boat will fly the "X" flag and signal in accordance with Rule 29.1, and MAY attempt to notify individual yacht(s) by hail. However, failure of a yacht to hear her recall shall not relieve her of her obligation to start correctly. There will be no general recalls.

12. THE FINISH

The finish line will be between an orange flag on the R/C boat and the North mark unless shortened or abandoned (See RRS 32).

13. TIME LIMIT

The time limit for each race will be **2 hours** for the first boat to finish in each division. Boats finishing more than **90 minutes** after the first boat that sails the course and finishes will be scored DNF. This changes RRS 35.

14. PROTESTS AND REQUESTS FOR REDRESS

Protest flags must be flown. Hearing Request Forms (formerly "Protest Forms") are available on the official notice board. Hearing Requests shall be delivered to the MBC Sail Fleet Board folder within 1.0 hour after the race committee/finish boat docks.

The yacht requesting a hearing must notify the R/C boat at the finish line of her intent to protest and the sail number of the protested yacht. Hearings will be held as soon as possible after racing in the Commodore's Room at the clubhouse. All interested parties must be present.

A boat that has taken a penalty under RRS 31 or 44.1 shall notify the Race Committee after it has finished the race.

15. SCORING

The Low Point System of Appendix A of the RRS will apply.

Spring/Summer series results will be calculated on the best five (5) scores in the respective series; this changes RRS Appendix A-2.1.

No makeup races will be scheduled if a race is cancelled for any reason.

Overall season results will be calculated on the best ten (10) scores over the 14 race season. Rum races are not included in overall scoring.

16. SAFETY

a. Each competitor is responsible for the personal safety of him/herself, his/her crew and yacht. It shall be the sole and inescapable responsibility of the skipper and crew of the yacht to decide whether or not to start, continue, or finish a race.

b. All yachts shall follow the U.S. Coast Guard requirements for carrying lights at night.

c. Each boat MUST monitor VHF Channel 71 during each race.

d. Retirement: A yacht that retires shall notify the Race Committee, verbally or using VHF channel 71, before leaving the racing area. If that is not possible, the yacht shall notify MBC as soon as possible. The club monitors VHF channel 16. Club telephone: (734) 243-8935.

e. The responsibility for a boat's decision to participate in a race or to continue to race is hers alone.' By participating in this event each competitor agrees and acknowledges that sailing is a potentially dangerous activity with inherent risks. These risks include strong winds and rough seas, sudden changes in weather, failure of equipment, boat handling errors, poor seamanship by other boats, loss of balance on an unstable platform and fatigue resulting in increased risk of injury. Inherent in the sport of sailing is the risk of permanent, catastrophic injury or death by drowning, trauma, hypothermia or other causes.

17. RADIO COMMUNICATION

From the first warning signal until the end of the last race of the day, except in an emergency, a boat shall not make voice or data transmissions and shall not receive voice or data communication that is not available to all boats. This restriction also applies to mobile (cell) telephones except to call the club at (734) 243-8935.

18. TROPHIES AND PRIZES

Award flags will be awarded to the top three finishers of each class at the Annual Banquet. Exceptions: only one flag per season is awarded in a class with only one boat. Overall Trophies for combined spring/summer series will be awarded to the top three finishers in each class (PHRF/JAM).

Exhibit "A"

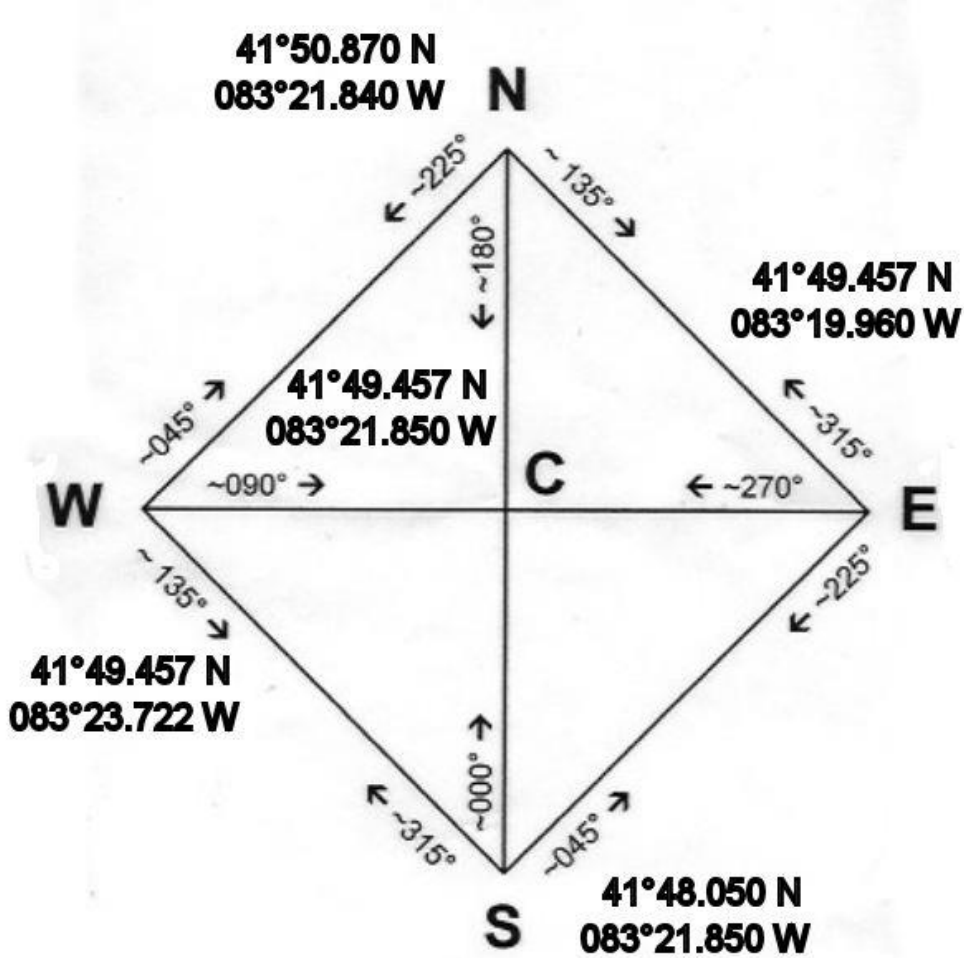

Buoy coordinates are approximate, and the buoys are subject to movement by storms. If a mark is missing, the competitors will use these coordinates to make a navigational rounding.